

GPS TRACKER USER MANUAL

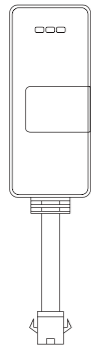

Please read the installation instruction manual carefully before installation and use.

1 Appearance

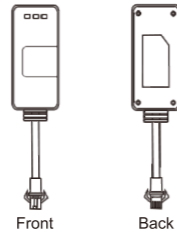

2 Product Features

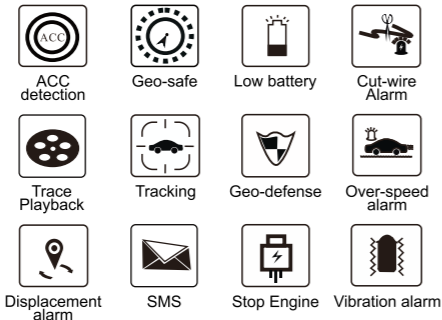

3 Wire connection

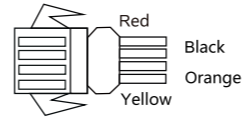

3.1 Terminal Description

| Status | Meaning |
|--------|-----------------|
| Red | POSITIVE(9-90V) |
| Black | Negative |
| Orange | Acc line |
| Yellow | Relay |

3.2 Red LED light (Power Supply Status)

| Status | Meaning |
|-------------|---------------------------------|
| Slow Blink | Normal(Internal battery supply) |
| Long Bright | Normal (external power) |
| Off | Broken or Sleeping |

3.3 Yellow LED light (GSM Status)

| Status | Meaning |
|-------------|----------------------------------|
| Quick Blink | Searching GSM Signal |
| Slow Blink | Normal Working |
| Off | GSM Searching Failed or Sleeping |

3.4 Blue LED light (GPS Status)

| Status | Meaning |
|-------------|----------------------------------|
| Quick Blink | Searching GPS Signal |
| Slow Blink | Normal Working |
| Off | GPS Searching Failed or Sleeping |

4 Installation

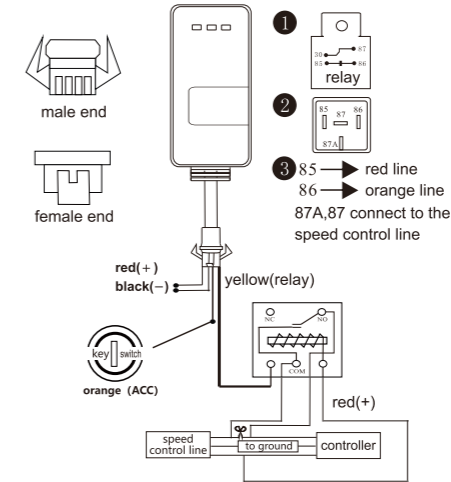

- Red line connect battery positive pole(+) black line connect battery negative pole(-).
- Orange line connect ACC line.
- Wiring for Cut-off oil function:
 - Find the 'Speed control line'.
 - Detect the voltage of 'Speed control line' by a millimeter.
 - Cut the 'Speed control line' into two lines.
 - Connect "Speed control lines" with relay's two green lines.

Note:

- Please use correct relay, normally, car suit 12V relay, truck suit for 24V relay..
- Open SIM card cover, insert SIM card and turn on battery supply.
- SIM card must have GPRS data and SMS service.
- Please make sure LED lights up and no steel matter covering the device.
- Please fix it by cable ties or tape.

5 Installation

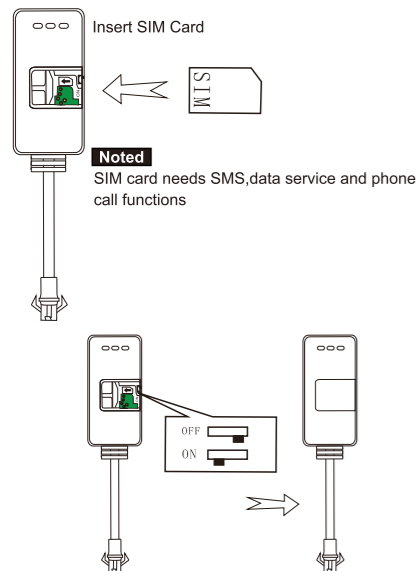

Noted
SIM card needs SMS,data service and phone call functions

6 Product Installation

Please find some guys who are experienced in GPS tracker installation

Installation Precautions :

- Device should be installed in somewhere waterproof and easy to be hidden.
- Please turn on the device battery switch before use it.
- Ensure device light in the front and there is no shield before install
- Secure with a cable tie or sponge double-sided tape

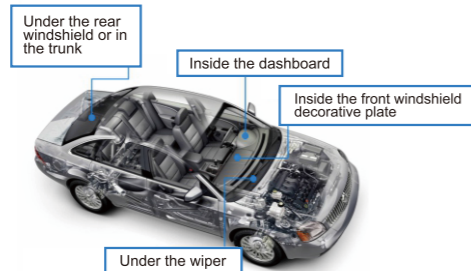

7 Precautions

GPS Tracker should be installed covertly, please contact the supplier for professional installation advice.

- Hidden installation, avoid water.
- Ensure the Led side facing sky and no metal cover.
- Use cable or 3m tape to fix the device.

8 Working Description

- After connected with vehicle battery, device will be turned on automatically and power indicator light (red) will be long bright.
- If the device is using its own back up battery, the power indicator light (red) will slowly blink after turned on manually.
- GSM signal light (yellow) and GPS signal light(blue) start fast blinking.
- A few seconds later both GSM light and GPS light will be steady and start slow blinking; device enters into normal working status.

9 Trouble Shooting

| Problem | Description | Solution |
|--------------------------------|--|---|
| Failed to connect the internet | SIM card not installed | Check the sim card |
| | Simcard not installed properly | Install again |
| | No GSM network | Move the device in gsm network area |
| Location failed | Weak GSM network | Move the device in strong GSM network area |
| | SIM card has no gprs functions | Contact Sim card supplier to activate the gprs function |
| No GPS location | Always reply "failed to get location" | Contact the supplier |
| | Some poor signal areas like basement, tunnels are not able to acquire GPS signals. | Move the device to open sky areas. |

10 Access to Platform

- Platform(www.iopgps.com)
- Android and iOS APP(Scan the qr code to download app)



There are two methods to login in the platform or app.

- Login by IMEI number(the 15 digits in the back of the device), password: the last 6 digits of imei number.
- Contact the supplier to create an account for you.